

HEAVY DUTY INDEX DRIVE

Product Overview

You are currently viewing:



E-Series HD Drives

Additional Indexing Products:



Servo Positioner
Rotary TableIN-GTB



RDM Dial Indexers IN-RDM



RA Right Angle Drives IN-RA



RD HD Dial Indexers IN-RD



MDE/HDE Indexers IN-MDE



RSD Flexible Servo Drives .. IN-RSD



RGS/RGD
Shaft/Flange Drives IN-RGS



Parallel Shaft/
Flange Drives IN-PAR



RNG Easy Access
Dial Indexers IN-RNG



Rite-Link Conveyors IN-RLC



Table-Top Modular
Conveyors IN-TTC



Heavy Duty
Modular Conveyors IN-HDC



LPP Linear Part Handles IN-LPP



RPP Rotating Part Handlers .. IN-RPP



Overload Clutches IN-CLU



Custom Cams IN-CAM

HEAVY DUTY INDEX DRIVE

Table of Contents

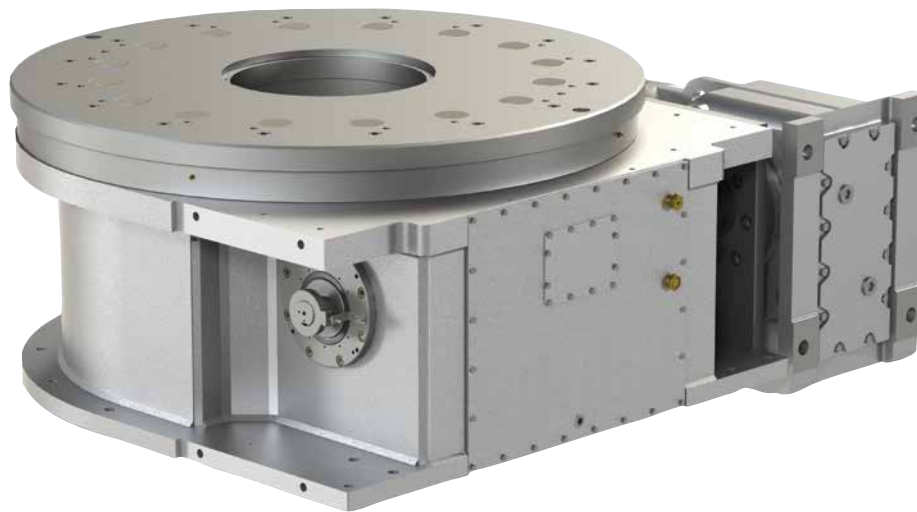

Features:

The **CAMCO E-Series Heavy Duty Index Drive** is ideal for heavy-duty rotary dial applications with features including:

Large output mounting surface supported by a 4-point contact bearing providing superior thrust and moment capacity

Large center thru-hole to accommodate stationary center post, electrical wiring and air or hydraulic lines

Complete motorized drive package with reducer and AC inverter drive to suit most applications

Precision cam with preloaded cam followers for maximum accuracy

Durable welded steel housing

Preloaded “center rib” design for smooth acceleration and deceleration with precision positioning

Table of Contents

How to Order	3
750E.....	5
950E.....	7
1150E.....	9
1550E.....	11

E-SERIES

Heavy Duty Index Drive | How To Order

Base Model Description

750E w/ KH87 reducer & 12.5 hp AC motor (220/440V)

950E w/ KH87 reducer & 15 hp AC motor (220/440V)

1150E w/ KH107 reducer & 25 hp AC motor (220/440V)

1550E w/ KH127 reducer & 30 hp AC motor (220/440V)

Control (only available with these models)

1 15 hp 240V 750E & 950E only

2 15 hp 440V 750E & 950E only

3 25 hp 240V 1150E only

4 25 hp 440V 1150E only

5 30 hp 240V 1550E only

6 30 hp 440V 1550E only

Motion	Stops	Index Period
A	2	330
B	3	330
C	4	330
D	6	330
E	8	330
F	12	330
G	16	330

Index Mounting	Reducer Ratio			
(See Figure 1)	750E	950E	1150E	1550E
1	A	14.50	29.00	40.19
2	B	19.95	42.33	54.07
3	C	24.92	49.90	70.95
4	D	31.39	52.17	81.98
5	E	44.02	66.52	89.89
6	F	49.16	73.30	110.18
	G	63.00	82.61	122.98

Reducer Mounting	Signal Switch	Signal Switch Side
(See Figure 3)		(See Figure 2)
A	M Mechanical	S Shaft
	P Proximity	

Example: MS or PS

Note about signal switch options:

a) Mechanical is a single switch with cam.

b) Proximity option is a mounting bracket for 8 or 12 mm proximity switch. A proximity switch will not be supplied. Cam supplied as target.

Other Motions (stops and index periods) available. Contact your DESTACO sales representative for more information.

Input Shaft Configuration/Rotations (Figure 1)

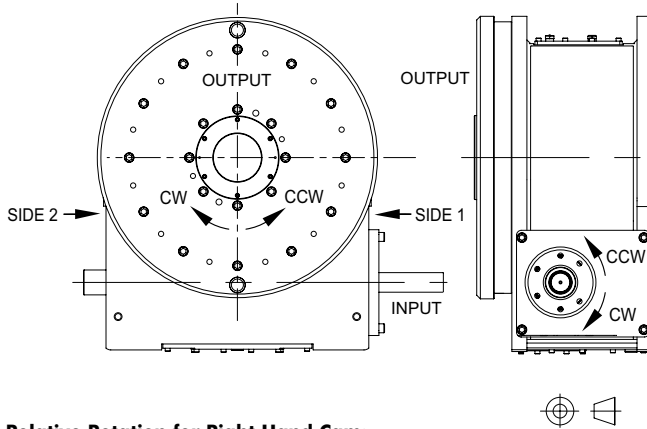

Relative Rotation for Right Hand Cam:

CW Input Side 1 CCW Output
CCW Input Side 2 CWW Output

NOTE: Input can be driven in either direction

Signal Switch Mounting Position (Figure 2)

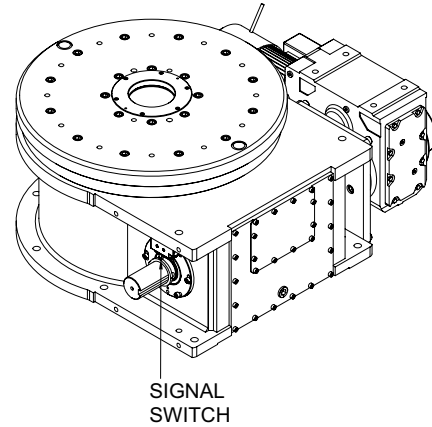

Gear Reducer Mounting Position (Figure 3)

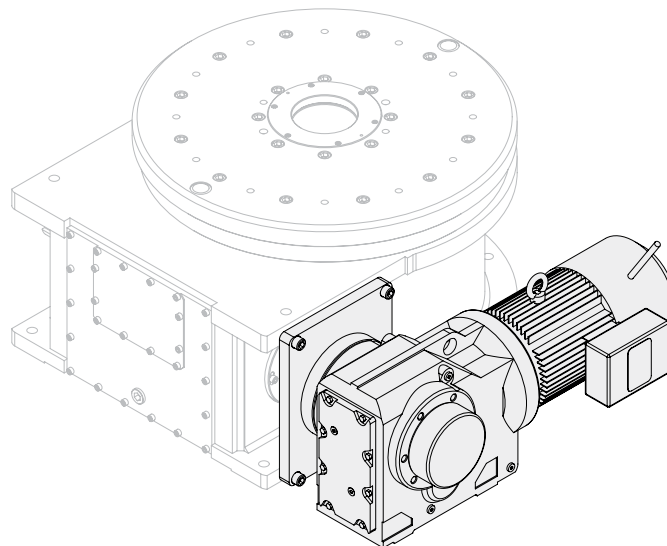

750E SERIES

Heavy Duty Index Drive | Dimensions

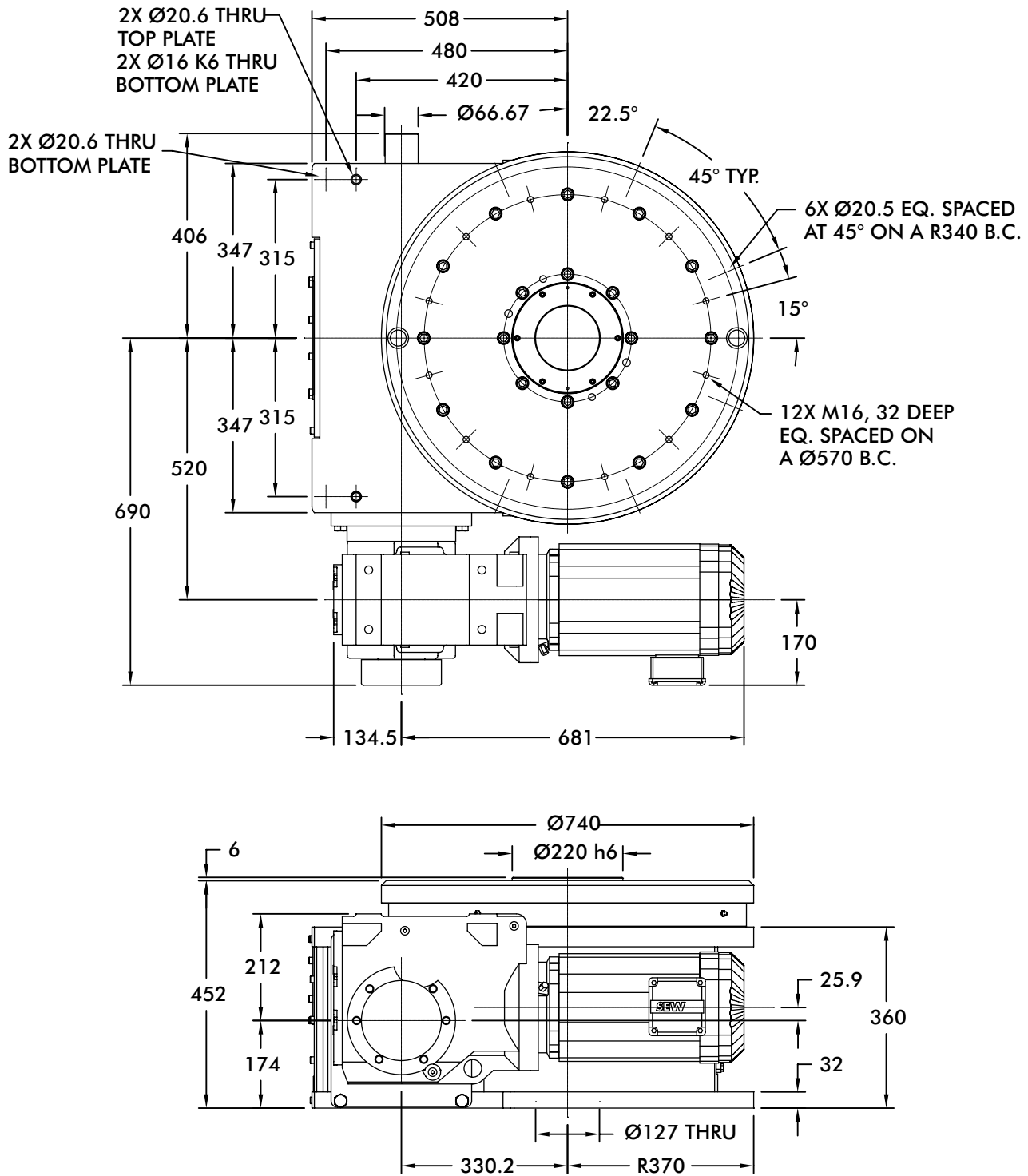

Unless otherwise noted,
all dimensions are in mm.

Maximum Inertia x 1,000 [lb-in ²] for standard package							
Stops	Motion Time [seconds]						
	0.44	0.59	0.76	0.96	1.35	1.50	1.93
2	0	27	105	254	751	987	1,647
3	14	98	257	562	1,577	2,058	3,407
4	67	231	542	1,140	3,128	4,072	6,714
6	191	542	1,209	2,491	6,756	8,781	14,447
8	372	931	1,677	2,841	5,587	6,968	11,444
12	886	2,291	4,840	8,195	16,116	20,100	33,010
16	1,351	2,717	4,837	8,254	16,263	20,283	33,311
Reducer Ratio							
	14.45	19.45	24.92	31.39	44.02	49.16	63.00

Features

- KH87 Gear Reducer with Brake-motor
- Double Extended Camshaft (Input shaft)
- Center Thru Hole (127 mm)
- Cycle Cam and Limit Switch
- Right Hand Cam

Optional Accessories

- Left Hand Cam
- Relief in Dwell for Shot-Pin applications
- Dual Cam & limit Switch
- KH97 Gear Reducer with Brake-motor
- Stationary Center Post
- Visual Disk Dwell Indicator

Output Load Capacity (loads carried during index):

Radial	29,200 lbs
Thrust/Axial	42,000 lbs
Moment	414,500 in-lbs

Typical Application

Dial Diameter:	55 in. to 110 in.
Accuracy	±27 arcsec / ±.002" at 15" Radius
Repeatability	±7 arcsec / ±.0005" at 15" Radius

950E SERIES

Heavy Duty Index Drive | Dimensions

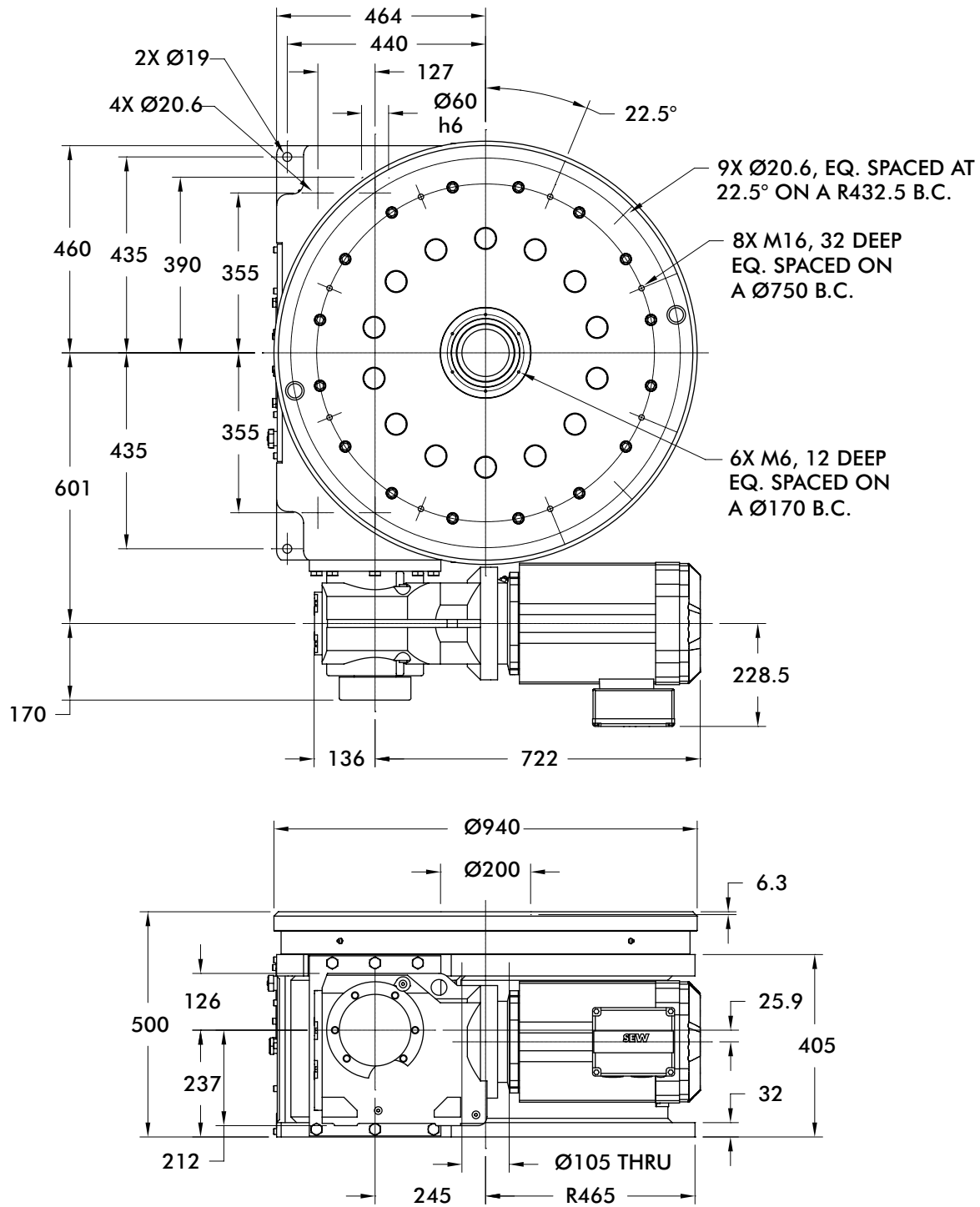

Unless otherwise noted,
all dimensions are in mm.

Maximum Inertia x 1,000 [lb-in ²] for standard package							
Stops	Motion Time [seconds]						
	0.44	0.59	0.76	0.96	1.35	1.50	1.93
2	0	0	61	224	619	833	1,433
3	0	59	250	619	1,507	1,989	3,337
4	16	205	564	1,252	2,911	3,810	6,329
6	187	634	1,479	3,102	7,013	9,135	15,073
8	412	1,169	2,603	5,287	11,478	14,315	23,511
12	1,025	2,729	5,956	10,793	23,621	30,484	53,172
16	1,290	2,647	4,753	8,147	17,305	21,582	35,445
Reducer Ratio							
	14.45	19.45	24.92	31.39	44.02	49.16	63.00

Features

- KH87 Gear Reducer with Brake-motor
- Double Extended Camshaft (Input shaft)
- Center Thru Hole (105 mm)
- Cycle Cam and Limit Switch
- Right Hand Cam

Optional Accessories

- Left Hand Cam
- Relief in Dwell for Shot-Pin applications
- Dual Cam & limit Switch
- KH97 Gear Reducer with Brake-motor
- Stationary Center Post
- Visual Disk Dwell Indicator

Output Load Capacity (loads carried during index):

Radial	52,600 lbs
Thrust/Axial	75,850 lbs
Moment	977,500 in-lbs

Typical Application

Dial Diameter:	70 in. to 140 in.
Accuracy	±29 arcsec / ±.0023" at 30" Radius
Repeatability	±6 arcsec / ±.0006" at 30" Radius

1150E SERIES

Heavy Duty Index Drive | Dimensions

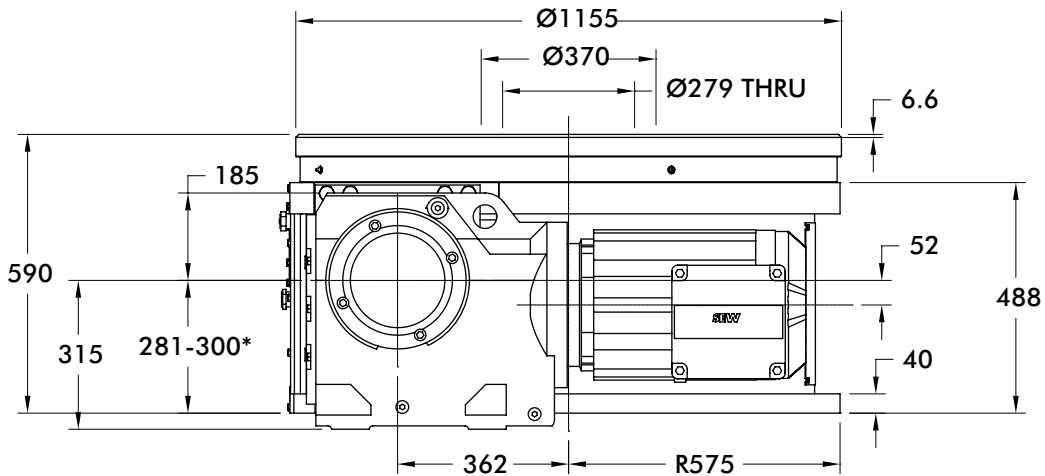
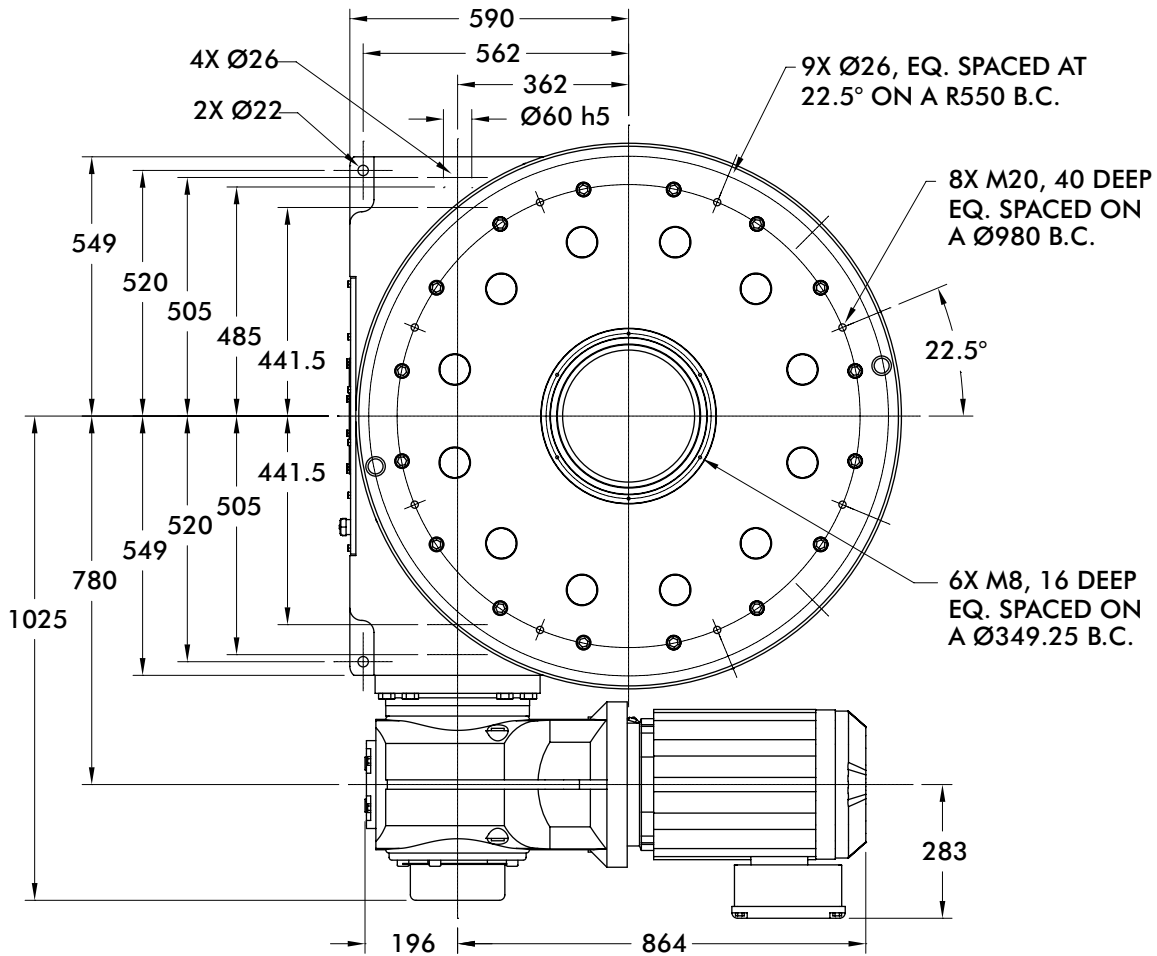

*281 OR 300 DEPENDING ON CAM MOTION

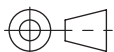

Unless otherwise noted,
all dimensions are in mm.

Maximum Inertia x 1,000 [lb-in ²] for standard package							
Stops	Motion Time [seconds]						
	0.89	1.29	1.52	1.75	2.03	2.24	2.52
2	134	1,141	2,093	3,329	4,746	5,835	7,501
3	698	2,965	5,108	7,887	11,077	13,526	17,275
4	1,445	5,474	9,284	14,225	19,896	24,249	30,915
6	3,780	12,845	21,419	32,537	45,296	55,090	70,088
8	6,581	21,959	36,502	54,381	73,624	89,397	113,548
12	15,621	50,221	82,944	123,772	167,569	203,468	258,436
16	27,975	61,083	84,884	111,420	150,846	183,162	232,645
Reducer Ratio							
	29.00	42.33	49.90	57.17	66.52	73.30	82.61

Features

- KH107 Gear Reducer with Brake-motor
- Double Extended Camshaft (Input shaft)
- Center Thru Hole (278 mm)
- Cycle Cam & limit Switch
- Right Hand Cam

Optional Accessories

- Left Hand Cam
- Relief in Dwell for Shot-Pin applications
- Dual Cam & limit Switch
- KH127 Gear Reducer with Brake-motor
- Stationary Center Post
- Visual Disk Dwell Indicator

Output Load Capacity (loads carried during index):

Radial	59,025 lbs
Thrust/Axial	85,470 lbs
Moment	1,469,000 in-lbs

Typical Application

Dial Diameter:	90 in. to 180 in.
Accuracy	±16 arcsec / ±.002" at 25" Radius
Repeatability	±4 arcsec / ±.0005" at 25" Radius

1550E SERIES

Heavy Duty Index Drive | Dimensions

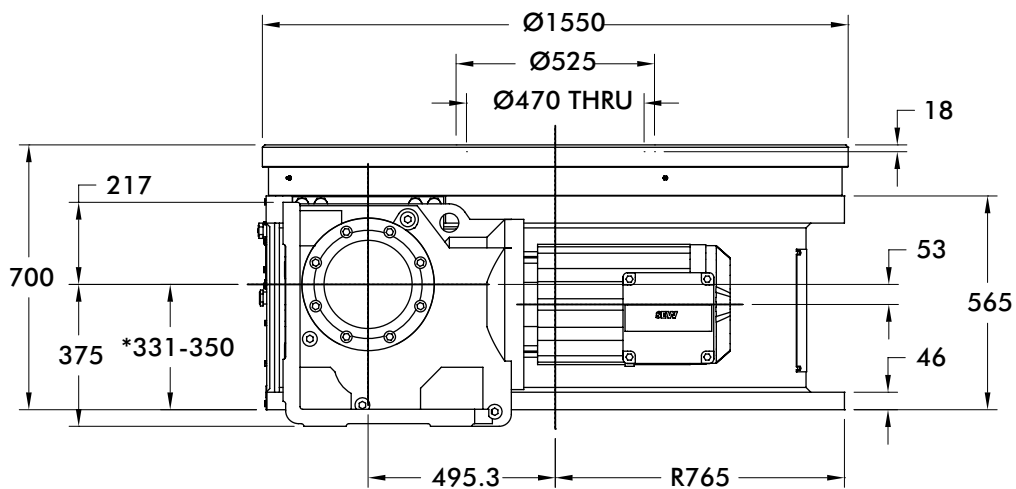
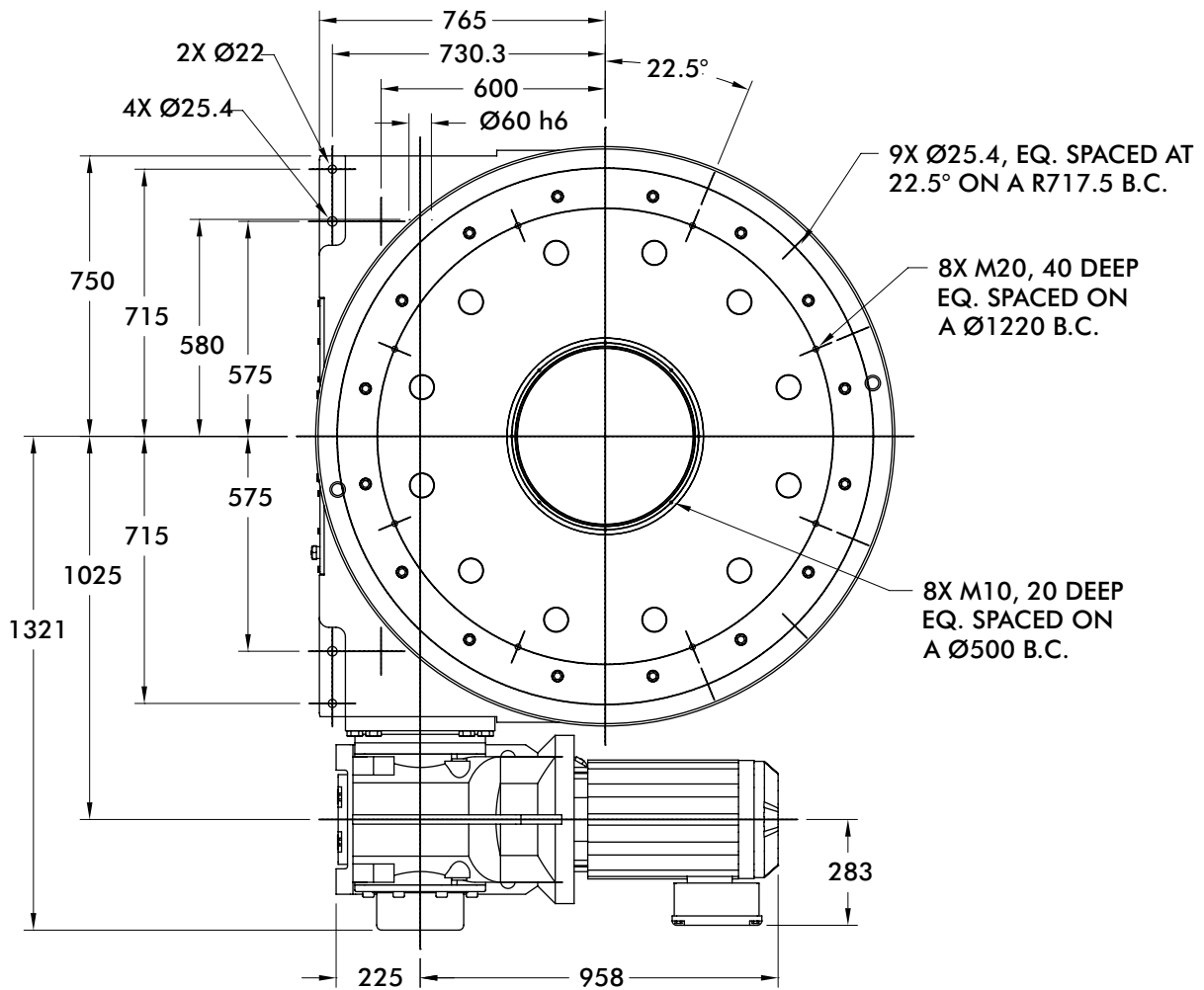

*331 OR 350 DEPENDING ON CAM MOTION



Unless otherwise noted,
all dimensions are in mm.

Maximum Inertia x 1,000 [lb-in ²] for standard package							
Stops	Motion Time [seconds]						
	1.23	1.65	2.17	2.50	2.75	3.37	3.74
2	0	1,926	6,208	10,388	13,740	21,944	26,735
3	1,811	6,814	17,561	28,054	36,466	57,057	69,084
4	4,396	13,172	32,028	50,439	65,198	101,324	122,426
6	11,290	30,132	70,615	110,143	141,829	219,391	264,696
8	22,185	57,289	132,712	195,668	235,249	353,436	436,753
12	50,005	125,372	287,302	445,415	572,159	882,406	1,038,461
16	89,910	206,224	355,085	474,071	569,968	856,314	1,038,461
Reducer Ratio							
	40.19	54.07	70.95	81.98	89.89	110.18	122.48

Features

- KH127 Gear Reducer with Brake-motor
- Double Extended Camshaft (Input shaft)
- Center Thru Hole (470 mm)
- Cycle Cam and Limit Switch
- Right Hand Cam

Optional Accessories

- Left Hand Cam
- Relief in Dwell for Shot-Pin applications
- Dual Cam & limit Switch
- KH157 Gear Reducer with Brake-motor
- Stationary Center Post
- Visual Disk Dwell Indicator

Output Load Capacity (loads carried during index):

Radial	82,600 lbs
Thrust/Axial	120,000 lbs
Moment	2,904,000 in-lbs

Typical Application

Dial Diameter:	118 in. to 236 in.
Accuracy	±12 arcsec / ±.0017" at 30" Radius
Repeatability	±3 arcsec / ±.0004" at 30" Radius